

**PRESERVATION OF MONUMENTS ACT
(CHAPTER 239, SECTION 8 (1))**

**PRESERVATION OF MONUMENTS
(CONSOLIDATION)
ORDER**

ARRANGEMENT OF PARAGRAPHS

Paragraph

1. Citation
 2. Monuments
The Schedule
-

Citation

1. This Order may be cited as the Preservation of Monuments (Consolidation) Order.

Monuments

2. The monuments specified in the Schedule are hereby placed under the protection of the Preservation of Monuments Board.

THE SCHEDULE

PART I

The building known as the Prinsep Street Presbyterian Church at Prinsep Street, Singapore and the whole of Lots 137-1 and 137-2 TS 12 comprising the said building, and more particularly delineated in the plan set out below.

PRINSEP STREET PRESBYTERIAN CHURCH

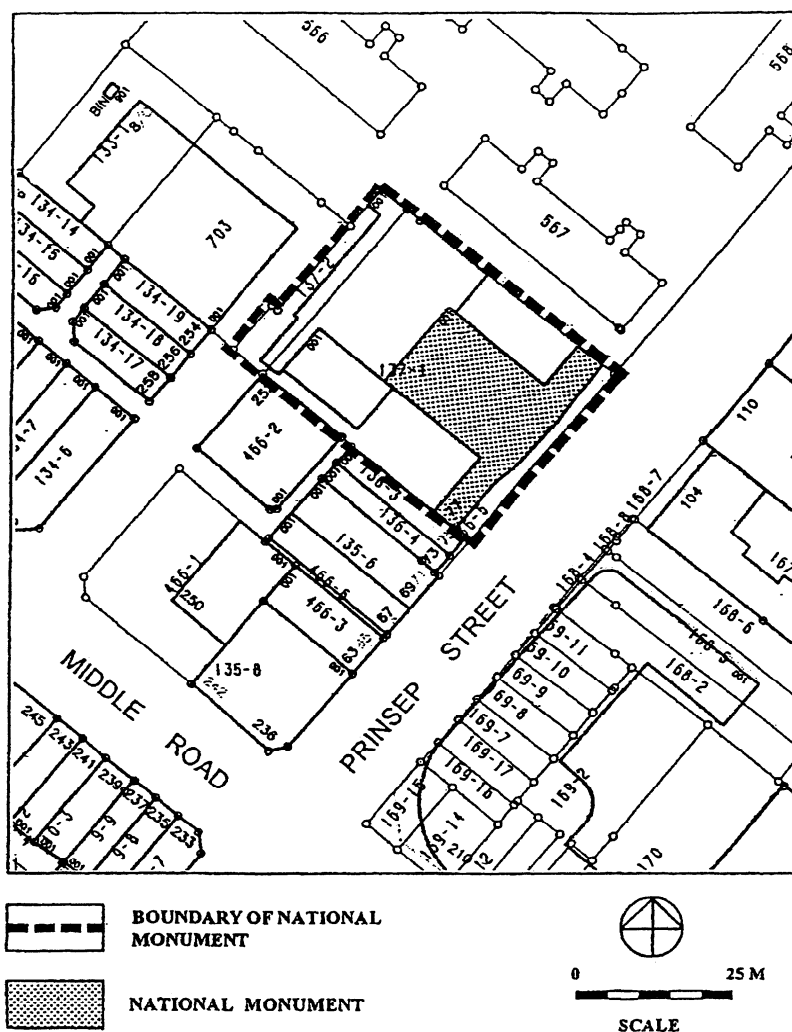

THE SCHEDULE — *continued*

PART II

- | <i>Description</i> | <i>Location</i> | | | | | | | | | | | | | | | | | | |
|---------------------------|----------------------------------------------------------------------------------------------------------------------------------------------------------------------------------------------------------------------------------------------------------------------------------------------------------------------------------------------------------------------------------------------------------------------------------------------------------------------------------------------------------------------------------------------------------------------------------------------------------------------------------------------------------------------------------------------------------------------------------------------------------------------------------------------------------------------------------------------------------------------------------------------------------------------------------------------------------------------------------------------------------------------------------------------------------------------------------------------------------------------------------------------------------------------------------------------------------------------------------------------------------------------------------------------------------------------------------------------|----------------|---------------------------|----------|-------|---------|------|----------|------|----------|-------|----------|-------|---------|-------|----------|------|---------|------|
| 1. Tan Teck Guan Building | <p>The building known as Tan Teck Guan Building erected on the land known as part Lot 369 MK 1 at College Road, Singapore, being within the boundary described as follows:</p> <p>Commencing at the northern-most corner of the monument of the aforesaid “Tan Teck Guan Building” which point is 29,233.15 metres North and 27,993.28 metres East of the Survey Department origin of co-ordinates, the boundaries run along successive lines of walls of bearings and distances as follows:</p> <table border="0"> <thead> <tr> <th style="text-align: left;"><i>Bearing</i></th> <th style="text-align: left;"><i>Distance in metres</i></th> </tr> </thead> <tbody> <tr><td>121° 42'</td><td>18.67</td></tr> <tr><td>31° 42'</td><td>0.61</td></tr> <tr><td>121° 42'</td><td>0.61</td></tr> <tr><td>211° 42'</td><td>15.37</td></tr> <tr><td>301° 42'</td><td>19.87</td></tr> <tr><td>31° 42'</td><td>15.36</td></tr> <tr><td>121° 42'</td><td>0.60</td></tr> <tr><td>31° 42'</td><td>0.62</td></tr> </tbody> </table> <p>to the point of commencement, and more particularly delineated in Plan 1.</p> <p>The boundaries of “Tan Teck Guan Building” are more particularly delineated and edged pink on the Preservation of Monuments Board Survey Plan No. TTG/1/02/001 filed in the office of the Preservation of Monuments Board.</p> | <i>Bearing</i> | <i>Distance in metres</i> | 121° 42' | 18.67 | 31° 42' | 0.61 | 121° 42' | 0.61 | 211° 42' | 15.37 | 301° 42' | 19.87 | 31° 42' | 15.36 | 121° 42' | 0.60 | 31° 42' | 0.62 |
| <i>Bearing</i> | <i>Distance in metres</i> | | | | | | | | | | | | | | | | | | |
| 121° 42' | 18.67 | | | | | | | | | | | | | | | | | | |
| 31° 42' | 0.61 | | | | | | | | | | | | | | | | | | |
| 121° 42' | 0.61 | | | | | | | | | | | | | | | | | | |
| 211° 42' | 15.37 | | | | | | | | | | | | | | | | | | |
| 301° 42' | 19.87 | | | | | | | | | | | | | | | | | | |
| 31° 42' | 15.36 | | | | | | | | | | | | | | | | | | |
| 121° 42' | 0.60 | | | | | | | | | | | | | | | | | | |
| 31° 42' | 0.62 | | | | | | | | | | | | | | | | | | |

THE SCHEDULE — *continued*

PART II — *continued*

PLAN 1

TAN TECK GUAN BUILDING

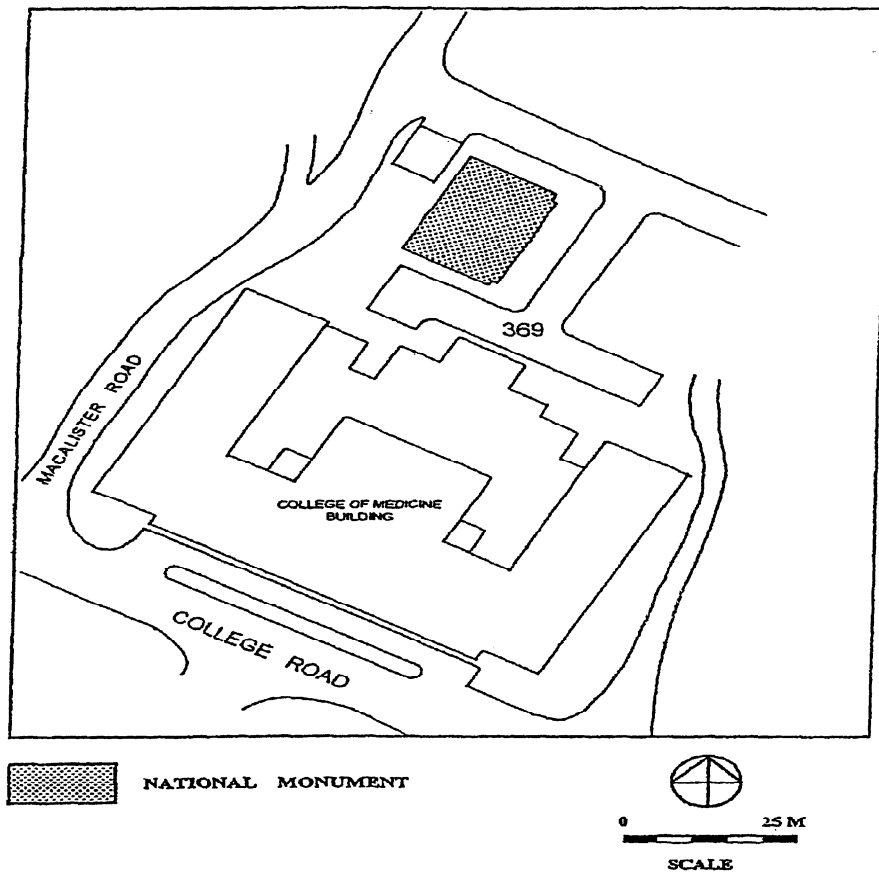

THE SCHEDULE — *continued*PART II — *continued*

<i>Description</i>	<i>Location</i>																																										
2. College of Medicine Building	<p>The building known as College of Medicine Building erected on the land known as part Lot 369 MK 1 at College Road, Singapore, being within the boundary described as follows:</p> <p>Commencing at the northern-most corner of the monument of the aforesaid “College of Medicine Building” which point is 29,250.56 metres North and 28,048.35 metres East of the Survey Department origin of co-ordinates, the boundaries run along successive lines of walls of bearings and distances as follows:</p> <table> <tr> <th><i>Bearing</i></th><th><i>Distance in metres</i></th></tr> <tr><td>121° 14'</td><td>45.00</td></tr> <tr><td>211° 14'</td><td>10.43</td></tr> <tr><td>120° 45'</td><td>1.99</td></tr> <tr><td>211° 13'</td><td>55.26</td></tr> <tr><td>302° 05'</td><td>1.97</td></tr> <tr><td>211° 00'</td><td>10.41</td></tr> <tr><td>301° 06'</td><td>45.03</td></tr> <tr><td>31° 13'</td><td>14.14</td></tr> <tr><td>120° 57'</td><td>0.60</td></tr> <tr><td>123° 22'</td><td>4.37</td></tr> <tr><td>121° 15'</td><td>24.49</td></tr> <tr><td>31° 12'</td><td>11.58</td></tr> <tr><td>301° 06'</td><td>14.77</td></tr> <tr><td>31° 08'</td><td>25.16</td></tr> <tr><td>121° 30'</td><td>14.88</td></tr> <tr><td>30° 39'</td><td>11.61</td></tr> <tr><td>301° 06'</td><td>19.47</td></tr> <tr><td>298° 55'</td><td>3.73</td></tr> <tr><td>300° 54'</td><td>6.27</td></tr> <tr><td>31° 17'</td><td>14.16</td></tr> </table> <p>to the point of commencement, and more particularly delineated in Plan 2.</p>	<i>Bearing</i>	<i>Distance in metres</i>	121° 14'	45.00	211° 14'	10.43	120° 45'	1.99	211° 13'	55.26	302° 05'	1.97	211° 00'	10.41	301° 06'	45.03	31° 13'	14.14	120° 57'	0.60	123° 22'	4.37	121° 15'	24.49	31° 12'	11.58	301° 06'	14.77	31° 08'	25.16	121° 30'	14.88	30° 39'	11.61	301° 06'	19.47	298° 55'	3.73	300° 54'	6.27	31° 17'	14.16
<i>Bearing</i>	<i>Distance in metres</i>																																										
121° 14'	45.00																																										
211° 14'	10.43																																										
120° 45'	1.99																																										
211° 13'	55.26																																										
302° 05'	1.97																																										
211° 00'	10.41																																										
301° 06'	45.03																																										
31° 13'	14.14																																										
120° 57'	0.60																																										
123° 22'	4.37																																										
121° 15'	24.49																																										
31° 12'	11.58																																										
301° 06'	14.77																																										
31° 08'	25.16																																										
121° 30'	14.88																																										
30° 39'	11.61																																										
301° 06'	19.47																																										
298° 55'	3.73																																										
300° 54'	6.27																																										
31° 17'	14.16																																										

THE SCHEDULE — *continued*PART II — *continued**Description**Location*

The boundaries of “College of Medicine Building” are more particularly delineated and edged pink on the Preservation of Monuments Board Survey Plan No. COM/1/02/001 filed in the office of the Preservation of Monuments Board.

PLAN 2

COLLEGE OF MEDICINE BUILDING

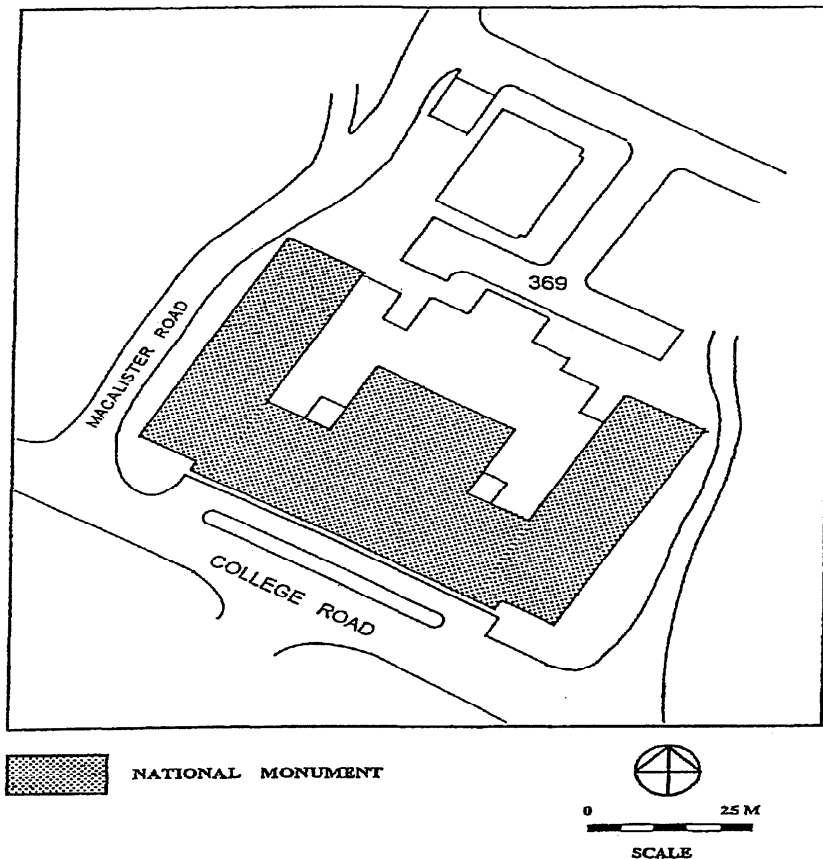

THE SCHEDULE — *continued*PART II — *continued*

<i>Description</i>	<i>Location</i>																																								
3. The Old Admiralty House	<p>The building known as The Old Admiralty House erected on the land known as part Lot 3686C MK 13 at Old Nelson Road, Singapore, being within the boundary described as follows:</p> <p>Commencing at the northern-most corner of the monument of the aforesaid “The Old Admiralty House” which point is 47,708.25 metres North and 27,027.94 metres East of the Survey Department origin of co-ordinates, the boundaries run along successive lines of walls of bearings and distances as follows:</p> <table> <tr> <th><i>Bearing</i></th><th><i>Distance in metres</i></th></tr> <tr><td>146° 29'</td><td>8.75</td></tr> <tr><td>125° 48'</td><td>1.75</td></tr> <tr><td>131° 40'</td><td>1.01</td></tr> <tr><td>136° 44'</td><td>1.58</td></tr> <tr><td>140° 59'</td><td>1.11</td></tr> <tr><td>145° 52'</td><td>1.50</td></tr> <tr><td>151° 23'</td><td>1.11</td></tr> <tr><td>155° 45'</td><td>1.51</td></tr> <tr><td>158° 27'</td><td>0.55</td></tr> <tr><td>164° 08'</td><td>0.56</td></tr> <tr><td>166° 21'</td><td>1.78</td></tr> <tr><td>146° 07'</td><td>8.79</td></tr> <tr><td>236° 26'</td><td>17.49</td></tr> <tr><td>326° 27'</td><td>8.91</td></tr> <tr><td>56° 18'</td><td>6.39</td></tr> <tr><td>326° 15'</td><td>11.78</td></tr> <tr><td>236° 24'</td><td>6.38</td></tr> <tr><td>326° 14'</td><td>13.80</td></tr> <tr><td>55° 20'</td><td>8.90</td></tr> </table>	<i>Bearing</i>	<i>Distance in metres</i>	146° 29'	8.75	125° 48'	1.75	131° 40'	1.01	136° 44'	1.58	140° 59'	1.11	145° 52'	1.50	151° 23'	1.11	155° 45'	1.51	158° 27'	0.55	164° 08'	0.56	166° 21'	1.78	146° 07'	8.79	236° 26'	17.49	326° 27'	8.91	56° 18'	6.39	326° 15'	11.78	236° 24'	6.38	326° 14'	13.80	55° 20'	8.90
<i>Bearing</i>	<i>Distance in metres</i>																																								
146° 29'	8.75																																								
125° 48'	1.75																																								
131° 40'	1.01																																								
136° 44'	1.58																																								
140° 59'	1.11																																								
145° 52'	1.50																																								
151° 23'	1.11																																								
155° 45'	1.51																																								
158° 27'	0.55																																								
164° 08'	0.56																																								
166° 21'	1.78																																								
146° 07'	8.79																																								
236° 26'	17.49																																								
326° 27'	8.91																																								
56° 18'	6.39																																								
326° 15'	11.78																																								
236° 24'	6.38																																								
326° 14'	13.80																																								
55° 20'	8.90																																								

THE SCHEDULE — *continued*PART II — *continued**Description**Location**Bearing**Distance in metres*

144° 59'

5.20

54° 59'

8.45

to the point of commencement, and more particularly delineated in Plan 3.

The boundaries of “The Old Admiralty House” are more particularly delineated and edged pink on the Preservation of Monuments Board Survey Plan No. OAH/1/02/001 filed in the office of the Preservation of Monuments Board.

PLAN 3

THE OLD ADMIRALTY HOUSE

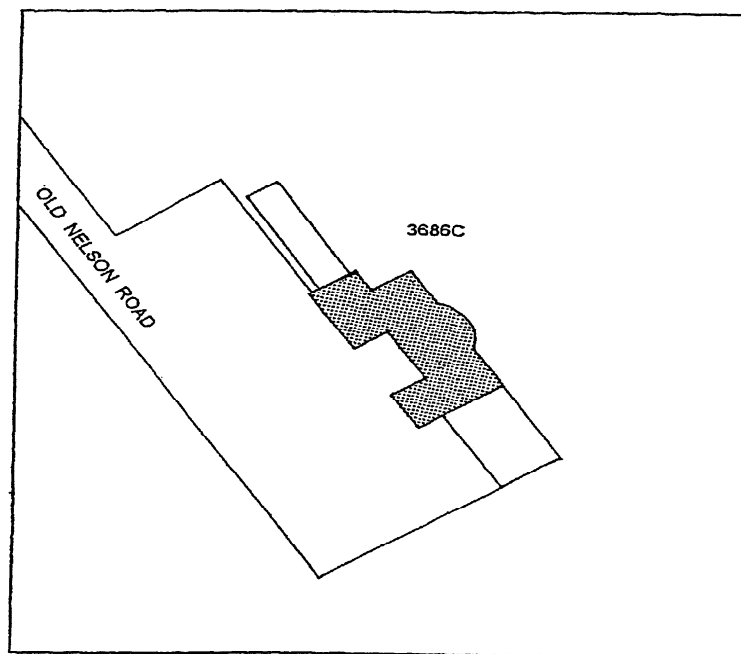

NATIONAL MONUMENT

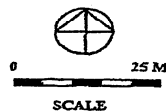

[S 609/2002 — 2.12.2002]

THE SCHEDULE — *continued*

PART III

<i>Description</i>	<i>Location</i>
--------------------	-----------------

1. Cathay Building

The building known as Cathay Building erected on the land known as part Lots 483 and 487 TS 19 at Handy Road, Singapore, being within the boundary described as follows:

Commencing at the northern-most corner of the monument of the aforesaid “Cathay Building” which point is 31,295.76 metres North and 29,633.72 metres East of the Singapore Land Authority origin of co-ordinates, the boundaries run along successive lines of walls of bearings and distances as follows:

<i>Bearing</i>	<i>Distance in metres</i>
170° 08'	12.31
223° 54'	2.51
260° 19'	4.32
170° 19'	1.88
260° 11'	15.15
350° 25'	1.89
260° 25'	4.60
299° 09'	2.36
346° 46'	1.55
260° 24'	5.93
350° 24'	2.65
260° 10'	3.98
298° 10'	4.91
290° 55'	2.81
291° 32'	3.83
330° 57'	0.83
350° 43'	0.81
80° 12'	47.79

to the point of commencement, and more particularly delineated in Plan 1.

THE SCHEDULE — continued

PART III — continued

Description

Location

The boundaries of “Cathay Building” are more particularly delineated and edged pink on the Preservation of Monuments Board Survey Plan No. CB/1/02/001 filed in the office of the Preservation of Monuments Board.

PLAN 1

CATHAY BUILDING

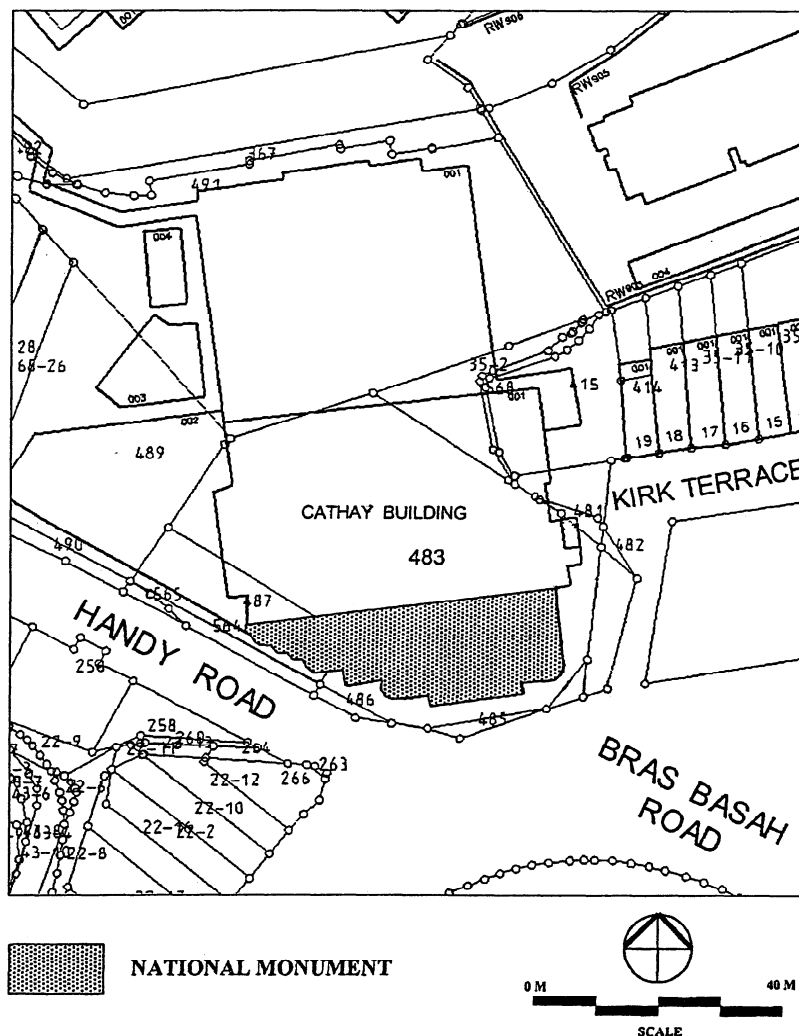

THE SCHEDULE — *continued*PART III — *continued*

<i>Description</i>	<i>Location</i>																																								
2. Church of Sts. Peter and Paul	<p>The building known as Church of Sts. Peter and Paul erected on the land known as Lot 459X TS 11 at Queen Street, Singapore, being within the boundary described as follows:</p> <p>Commencing at the northern-most corner of the monument of the aforesaid “Church of Sts. Peter and Paul” which point is 31,160.91 metres North and 29,989.75 metres East of the Singapore Land Authority origin of co-ordinates, the boundaries run along successive lines of walls of bearings and distances as follows:</p> <table> <tr> <th><i>Bearing</i></th><th><i>Distance in metres</i></th></tr> <tr><td>130° 44'</td><td>3.2</td></tr> <tr><td>43° 54'</td><td>0.55</td></tr> <tr><td>129° 44'</td><td>0.43</td></tr> <tr><td>41° 58'</td><td>0.45</td></tr> <tr><td>130° 50'</td><td>2.56</td></tr> <tr><td>132° 00'</td><td>5.43</td></tr> <tr><td>131° 46'</td><td>2.61</td></tr> <tr><td>219° 24'</td><td>0.44</td></tr> <tr><td>132° 35'</td><td>0.44</td></tr> <tr><td>222° 43'</td><td>0.96</td></tr> <tr><td>309° 31'</td><td>0.44</td></tr> <tr><td>221° 33'</td><td>4.52</td></tr> <tr><td>131° 21'</td><td>3.29</td></tr> <tr><td>44° 41'</td><td>0.43</td></tr> <tr><td>131° 34'</td><td>18.36</td></tr> <tr><td>41° 34'</td><td>0.32</td></tr> <tr><td>131° 27'</td><td>7.12</td></tr> <tr><td>221° 13'</td><td>0.64</td></tr> <tr><td>131° 13'</td><td>0.16</td></tr> </table>	<i>Bearing</i>	<i>Distance in metres</i>	130° 44'	3.2	43° 54'	0.55	129° 44'	0.43	41° 58'	0.45	130° 50'	2.56	132° 00'	5.43	131° 46'	2.61	219° 24'	0.44	132° 35'	0.44	222° 43'	0.96	309° 31'	0.44	221° 33'	4.52	131° 21'	3.29	44° 41'	0.43	131° 34'	18.36	41° 34'	0.32	131° 27'	7.12	221° 13'	0.64	131° 13'	0.16
<i>Bearing</i>	<i>Distance in metres</i>																																								
130° 44'	3.2																																								
43° 54'	0.55																																								
129° 44'	0.43																																								
41° 58'	0.45																																								
130° 50'	2.56																																								
132° 00'	5.43																																								
131° 46'	2.61																																								
219° 24'	0.44																																								
132° 35'	0.44																																								
222° 43'	0.96																																								
309° 31'	0.44																																								
221° 33'	4.52																																								
131° 21'	3.29																																								
44° 41'	0.43																																								
131° 34'	18.36																																								
41° 34'	0.32																																								
131° 27'	7.12																																								
221° 13'	0.64																																								
131° 13'	0.16																																								

THE SCHEDULE — *continued*PART III — *continued*

<i>Description</i>	<i>Location</i>	
	<i>Bearing</i>	<i>Distance in metres</i>
	41° 13'	0.33
	133° 06'	0.97
	218° 14'	0.44
	131° 28'	4.94
	221° 21'	12.51
	311° 11'	4.94
	221° 34'	0.43
	311° 23'	0.93
	39° 41'	0.38
	309° 10'	0.36
	222° 04'	0.72
	311° 26'	6.98
	41° 30'	0.34
	311° 39'	18.39
	39° 11'	0.40
	312° 19'	3.28
	221° 40'	4.55
	132° 24'	0.44
	221° 26'	0.96
	308° 03'	0.44
	223° 34'	0.44
	311° 22'	2.59
	311° 31'	5.43
	311° 19'	2.55
	37° 59'	0.46
	313° 25'	0.44
	41° 26'	0.53
	312° 57'	3.21

THE SCHEDULE — *continued*PART III — *continued*

<i>Description</i>	<i>Location</i>	
	<i>Bearing</i>	<i>Distance in metres</i>
	40° 59'	4.43
	314° 07'	0.54
	38° 20'	0.43
	314° 05'	0.44
	40° 56'	0.94
	131° 43'	0.45
	41° 43'	2.26
	341° 02'	2.14
	281° 39'	0.90
	11° 21'	0.95
	101° 24'	0.94
	41° 03'	2.31
	340° 29'	0.90
	70° 12'	0.95
	160° 18'	0.94
	101° 29'	2.11
	41° 24'	2.24
	311° 24'	0.44
	41° 03'	0.96
	130° 07'	0.45
	43° 34'	0.45
	130° 04'	0.56
	41° 42'	4.44

to the point of commencement, and more particularly delineated in Plan 2.

The boundaries of “Church of Sts. Peter and Paul” are more particularly delineated and edged pink on the Preservation of Monuments Board Survey Plan No. MH/1/02/001 filed in the office of the Preservation of Monuments Board.

THE SCHEDULE — *continued*

PART III — *continued*

PLAN 2

CHURCH OF STS. PETER AND PAUL

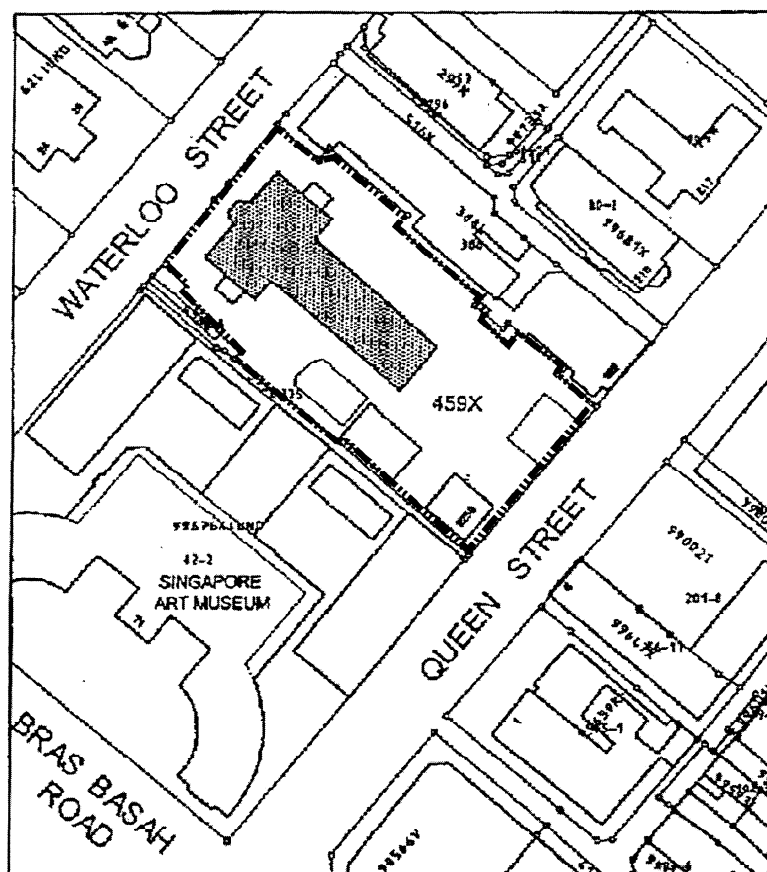

NATIONAL MONUMENT



BOUNDARY OF
NATIONAL MONUMENT



THE SCHEDULE — continued

PART III — continued

Description	Location
3. MacDonald House	<p>The building known as MacDonald House erected on the land known as Lot 172-3 TS 19 at Orchard Road, Singapore.</p> <p>The boundaries of “MacDonald House” are more particularly delineated and edged pink on the Preservation of Monuments Board Survey Plan No. CSPP/1/02/001 filed in the office of the Preservation of Monuments Board.</p>

PLAN 3

MACDONALD HOUSE

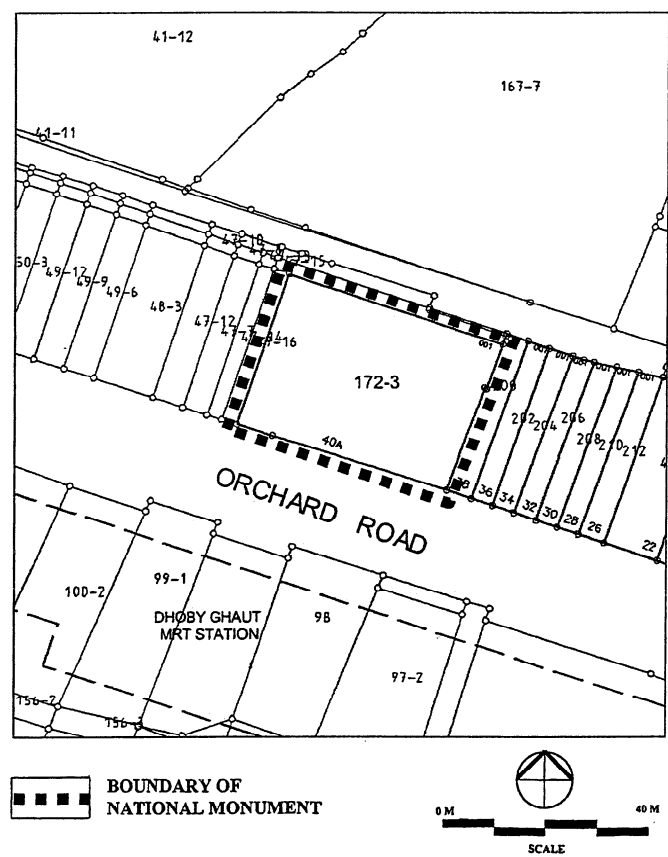

[S 60/2003 — 10.2.2003]

THE SCHEDULE — *continued*

PART IV

- | <i>Description</i> | <i>Location</i> | | | | | | | | | | | | | | | | | | | | | | | | | | | | | | | | | | | | | | | | | | |
|----------------------------|-----------------------------------------------------------------------------------------------------------------------------------------------------------------------------------------------------------------------------------------------------------------------------------------------------------------------------------------------------------------------------------------------------------------------------------------------------------------------------------------------------------------------------------------------------------------------------------------------------------------------------------------------------------------------------------------------------------------------------------------------------------------------------------------------------------------------------------------------------------------------------------------------------------------------------------------------------------------------------------------------------------------------------------------------------------------------------------------------------------------------------------------------------------------------------------------------------------------------------------------------------------------------------------------------------------------------------------------------------------------------------------------------------------------------------------------------------------------------------------------------------------------------------------------|----------------|---------------------------|----------|-------|----------|-------|----------|-------|---------|------|----------|------|----------|------|----------|------|----------|------|----------|-------|----------|------|----------|-------|----------|------|----------|------|----------|------|----------|------|---------|------|----------|-------|----------|-------|----------|-------|---------|-------|
| 1. RC Church of St. Joseph | <p>The building known as RC Church of St. Joseph erected on the land known as Lot 464C TS 11 at Victoria Street, Singapore, being within the boundary described as follows:</p> <p>Commencing at the northern-most corner of the monument of the aforesaid “RC Church of St. Joseph” which point is 31,221.14 metres North and 30,205.71 metres East of the Singapore Land Authority origin of co-ordinates, the boundaries run along successive lines of walls of bearings and distances as follows:</p> <table border="0"> <thead> <tr> <th style="text-align: left;"><i>Bearing</i></th> <th style="text-align: left;"><i>Distance in metres</i></th> </tr> </thead> <tbody> <tr><td>129° 05'</td><td>13.60</td></tr> <tr><td>219° 10'</td><td>12.81</td></tr> <tr><td>128° 50'</td><td>22.01</td></tr> <tr><td>39° 39'</td><td>2.08</td></tr> <tr><td>129° 44'</td><td>5.50</td></tr> <tr><td>219° 16'</td><td>3.94</td></tr> <tr><td>128° 01'</td><td>2.20</td></tr> <tr><td>218° 05'</td><td>4.53</td></tr> <tr><td>128° 54'</td><td>10.17</td></tr> <tr><td>219° 02'</td><td>7.43</td></tr> <tr><td>309° 15'</td><td>10.25</td></tr> <tr><td>218° 44'</td><td>4.53</td></tr> <tr><td>307° 00'</td><td>2.25</td></tr> <tr><td>218° 49'</td><td>3.97</td></tr> <tr><td>309° 09'</td><td>5.48</td></tr> <tr><td>39° 14'</td><td>2.11</td></tr> <tr><td>308° 56'</td><td>22.05</td></tr> <tr><td>218° 56'</td><td>12.79</td></tr> <tr><td>308° 49'</td><td>13.52</td></tr> <tr><td>38° 57'</td><td>12.78</td></tr> </tbody> </table> | <i>Bearing</i> | <i>Distance in metres</i> | 129° 05' | 13.60 | 219° 10' | 12.81 | 128° 50' | 22.01 | 39° 39' | 2.08 | 129° 44' | 5.50 | 219° 16' | 3.94 | 128° 01' | 2.20 | 218° 05' | 4.53 | 128° 54' | 10.17 | 219° 02' | 7.43 | 309° 15' | 10.25 | 218° 44' | 4.53 | 307° 00' | 2.25 | 218° 49' | 3.97 | 309° 09' | 5.48 | 39° 14' | 2.11 | 308° 56' | 22.05 | 218° 56' | 12.79 | 308° 49' | 13.52 | 38° 57' | 12.78 |
| <i>Bearing</i> | <i>Distance in metres</i> | | | | | | | | | | | | | | | | | | | | | | | | | | | | | | | | | | | | | | | | | | |
| 129° 05' | 13.60 | | | | | | | | | | | | | | | | | | | | | | | | | | | | | | | | | | | | | | | | | | |
| 219° 10' | 12.81 | | | | | | | | | | | | | | | | | | | | | | | | | | | | | | | | | | | | | | | | | | |
| 128° 50' | 22.01 | | | | | | | | | | | | | | | | | | | | | | | | | | | | | | | | | | | | | | | | | | |
| 39° 39' | 2.08 | | | | | | | | | | | | | | | | | | | | | | | | | | | | | | | | | | | | | | | | | | |
| 129° 44' | 5.50 | | | | | | | | | | | | | | | | | | | | | | | | | | | | | | | | | | | | | | | | | | |
| 219° 16' | 3.94 | | | | | | | | | | | | | | | | | | | | | | | | | | | | | | | | | | | | | | | | | | |
| 128° 01' | 2.20 | | | | | | | | | | | | | | | | | | | | | | | | | | | | | | | | | | | | | | | | | | |
| 218° 05' | 4.53 | | | | | | | | | | | | | | | | | | | | | | | | | | | | | | | | | | | | | | | | | | |
| 128° 54' | 10.17 | | | | | | | | | | | | | | | | | | | | | | | | | | | | | | | | | | | | | | | | | | |
| 219° 02' | 7.43 | | | | | | | | | | | | | | | | | | | | | | | | | | | | | | | | | | | | | | | | | | |
| 309° 15' | 10.25 | | | | | | | | | | | | | | | | | | | | | | | | | | | | | | | | | | | | | | | | | | |
| 218° 44' | 4.53 | | | | | | | | | | | | | | | | | | | | | | | | | | | | | | | | | | | | | | | | | | |
| 307° 00' | 2.25 | | | | | | | | | | | | | | | | | | | | | | | | | | | | | | | | | | | | | | | | | | |
| 218° 49' | 3.97 | | | | | | | | | | | | | | | | | | | | | | | | | | | | | | | | | | | | | | | | | | |
| 309° 09' | 5.48 | | | | | | | | | | | | | | | | | | | | | | | | | | | | | | | | | | | | | | | | | | |
| 39° 14' | 2.11 | | | | | | | | | | | | | | | | | | | | | | | | | | | | | | | | | | | | | | | | | | |
| 308° 56' | 22.05 | | | | | | | | | | | | | | | | | | | | | | | | | | | | | | | | | | | | | | | | | | |
| 218° 56' | 12.79 | | | | | | | | | | | | | | | | | | | | | | | | | | | | | | | | | | | | | | | | | | |
| 308° 49' | 13.52 | | | | | | | | | | | | | | | | | | | | | | | | | | | | | | | | | | | | | | | | | | |
| 38° 57' | 12.78 | | | | | | | | | | | | | | | | | | | | | | | | | | | | | | | | | | | | | | | | | | |

<i>Bearing</i>	<i>Distance in metres</i>
129° 05'	13.60
219° 10'	12.81
128° 50'	22.01
39° 39'	2.08
129° 44'	5.50
219° 16'	3.94
128° 01'	2.20
218° 05'	4.53
128° 54'	10.17
219° 02'	7.43
309° 15'	10.25
218° 44'	4.53
307° 00'	2.25
218° 49'	3.97
309° 09'	5.48
39° 14'	2.11
308° 56'	22.05
218° 56'	12.79
308° 49'	13.52
38° 57'	12.78

THE SCHEDULE — *continued*PART IV — *continued*

<i>Description</i>	<i>Location</i>	
	<i>Bearing</i>	<i>Distance in metres</i>
	308° 39'	6.40
	353° 40'	8.47
	39° 08'	8.51
	84° 24'	8.41
	129° 17'	6.40
	38° 59'	12.78

to the point of commencement, and more particularly delineated in Plan 1.

The boundaries of “RC Church of St. Joseph” are more particularly delineated and edged pink on the Preservation of Monuments Board Survey Plan No. CSJ/1/05/001 filed in the office of the Preservation of Monuments Board.

THE SCHEDULE — *continued*

PART IV — *continued*

PLAN 1

RC CHURCH OF ST. JOSEPH

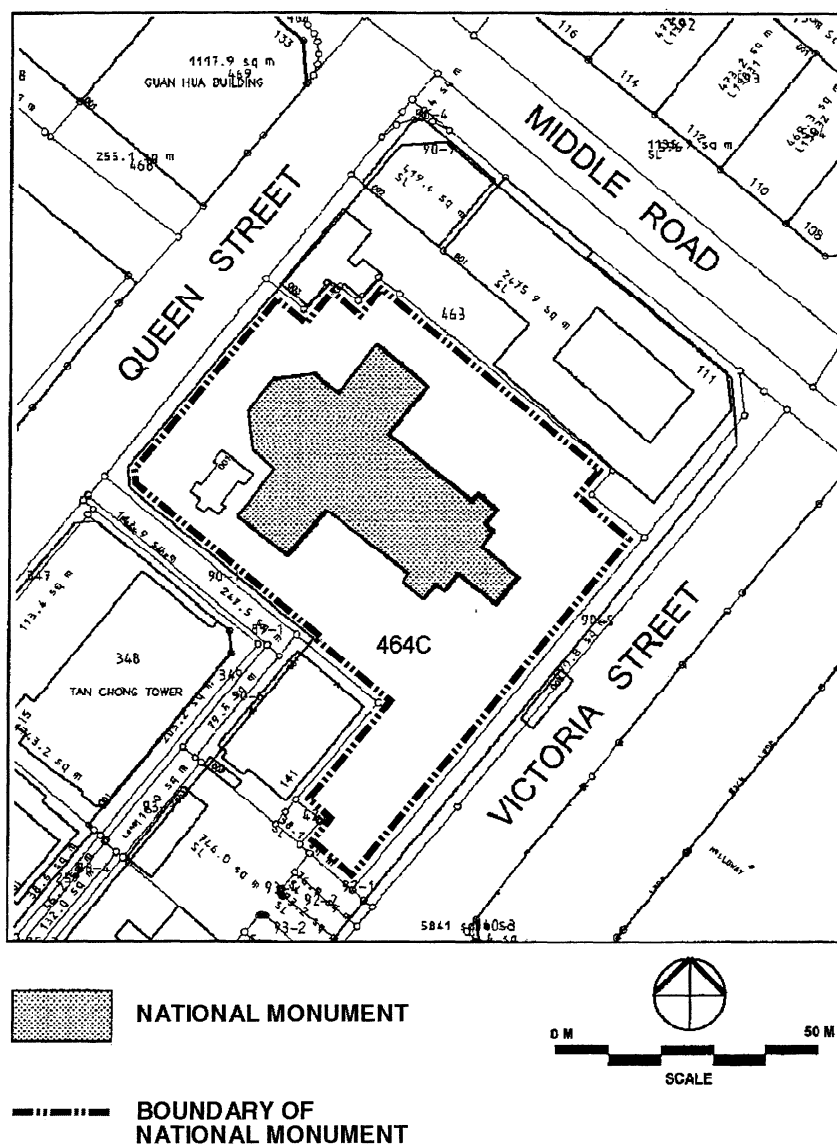

THE SCHEDULE — *continued*PART IV — *continued*

<i>Description</i>	<i>Location</i>
2. Church of Our Lady of Lourdes	The building known as Church of Our Lady of Lourdes erected on the land known as Lot 613 MK 13 at Ophir Road, Singapore, being within the boundary described as follows:

Commencing at the northern-most corner of the monument of the aforesaid “Church of Our Lady of Lourdes” which point is 31,742.58 metres North and 30,542.99 metres East of the Singapore Land Authority origin of co-ordinates, the boundaries run along successive lines of walls of bearings and distances as follows:

<i>Bearing</i>	<i>Distance in metres</i>
135° 19'	7.34
225° 47'	3.02
161° 53'	0.74
194° 03'	3.72
196° 14'	4.38
225° 04'	25.30
315° 19'	5.65
225° 31'	5.16
314° 51'	5.64
45° 02'	5.18
315° 05'	5.65
45° 18'	25.38
74° 40'	4.33
77° 01'	3.73
104° 58'	0.91
44° 42'	2.94

to the point of commencement, and more particularly delineated in Plan 2.

THE SCHEDULE — *continued*PART IV — *continued**Description**Location*

The boundaries of “Church of Our Lady of Lourdes” are more particularly delineated and edged pink on the Preservation of Monuments Board Survey Plan No. CLL/1/05/001 filed in the office of the Preservation of Monuments Board.

PLAN 2

CHURCH OF OUR LADY OF LOURDES

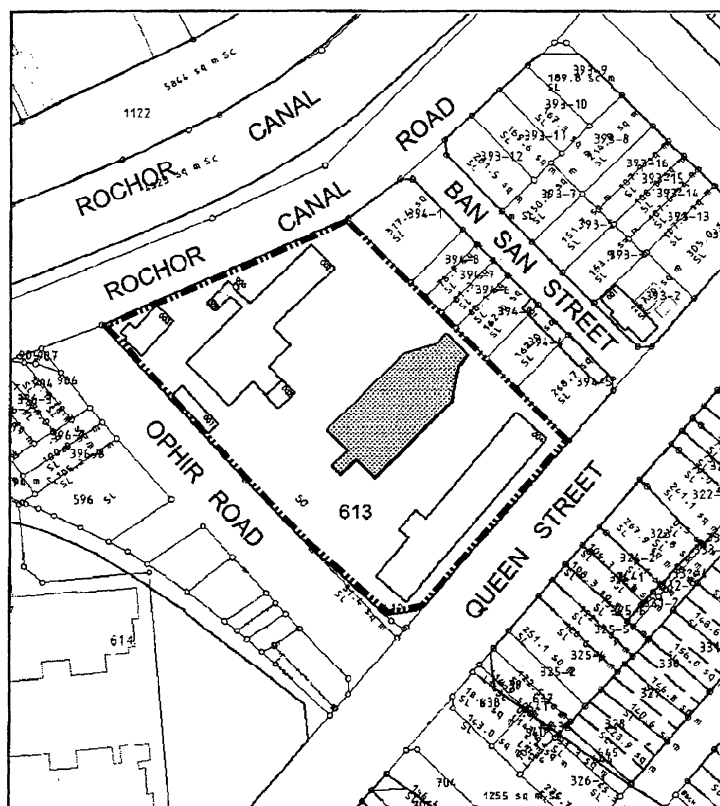

NATIONAL MONUMENT

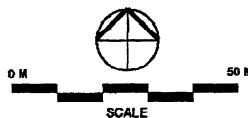
BOUNDARY OF
NATIONAL MONUMENT

THE SCHEDULE — *continued*PART IV — *continued*

<i>Description</i>	<i>Location</i>
3. Church of Nativity of The Blessed Virgin Mary	The building known as Church of Nativity of The Blessed Virgin Mary erected on the land known as Lot 8962X MK 22 at Upper Serangoon Road, Singapore, being within the boundary described as follows:

Commencing at the northern-most corner of the monument of the aforesaid “Church of Nativity of The Blessed Virgin Mary” which point is 39,531.58 metres North and 35,223.94 metres East of the Singapore Land Authority origin of co-ordinates, the boundaries run along successive lines of walls of bearings and distances as follows:

<i>Bearing</i>	<i>Distance in metres</i>
137° 13'	4.32
46° 55'	3.35
137° 13'	17.02
226° 51'	9.18
137° 13'	30.49
227° 21'	4.41
137° 21'	5.30
227° 09'	8.08
317° 21'	5.32
227° 21'	4.50
317° 20'	30.35
226° 51'	9.16
317° 10'	17.06
46° 55'	3.36
317° 11'	4.28
46° 51'	5.81
317° 13'	1.77
46° 33'	1.74
1° 23'	6.68

THE SCHEDULE — *continued*PART IV — *continued*

<i>Description</i>	<i>Location</i>	
	<i>Bearing</i>	<i>Distance in metres</i>
	46° 39'	4.08
	92° 09'	6.71
	46° 41'	1.74
	136° 56'	1.80
	46° 51'	5.80

to the point of commencement, and more particularly delineated in Plan 3.

The boundaries of “Church of Nativity of The Blessed Virgin Mary” are more particularly delineated and edged pink on the Preservation of Monuments Board Survey Plan No. CNBVM/1/05/001 filed in the office of the Preservation of Monuments Board.

THE SCHEDULE — *continued*

PART IV — *continued*

PLAN 3

CHURCH OF NATIVITY OF THE BLESSED VIRGIN MARY

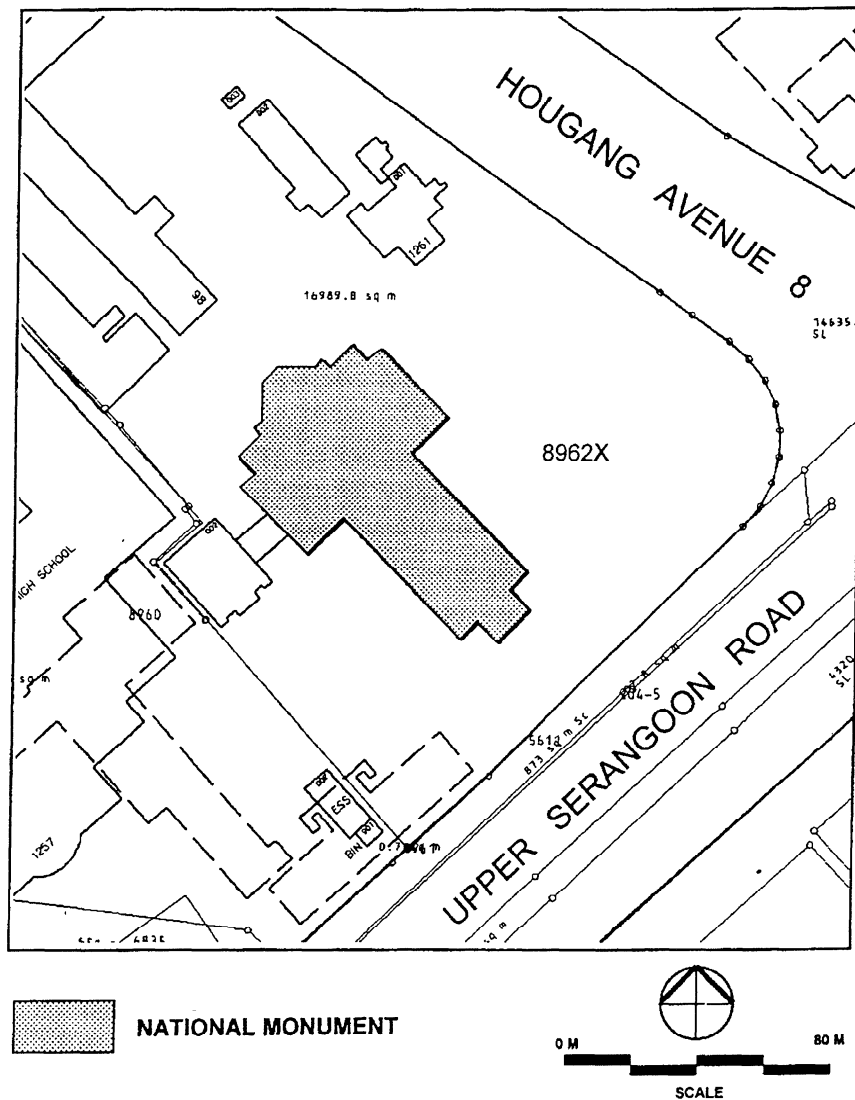

31.3.2005

THE SCHEDULE — *continued*PART IV — *continued*

<i>Description</i>	<i>Location</i>
4. Tou Mu Kung Temple	The building known as Tou Mu Kung Temple erected on the land known as Lot 7823 MK 22 at Upper Serangoon Road, Singapore, being within the boundary described as follows:

Commencing at the northern-most corner of the monument of the aforesaid “Tou Mu Kung Temple” which point is 37,483.68 metres North and 33,068.25 metres East of the Singapore Land Authority origin of co-ordinates, the boundaries run along successive lines of walls of bearings and distances as follows:

<i>Bearing</i>	<i>Distance in metres</i>
127° 46'	2.00
164° 46'	1.90
77° 20'	2.40
166° 23'	1.86
76° 05'	3.35
166° 41'	11.57
88° 53'	0.10
162° 50'	0.47
256° 29'	16.18
347° 32'	0.45
73° 24'	0.11
346° 44'	11.73
77° 48'	3.32
346° 51'	1.87
76° 29'	2.54
344° 40'	1.91
22° 46'	2.00
79° 42'	1.88

to the point of commencement, and more particularly delineated in Plan 4.

THE SCHEDULE — *continued*PART IV — *continued**Description**Location*

The boundaries of “Tou Mu Kung Temple” are more particularly delineated and edged pink on the Preservation of Monuments Board Survey Plan No. TMK/1/05/001 filed in the office of the Preservation of Monuments Board.

PLAN 4

TOU MU KUNG TEMPLE

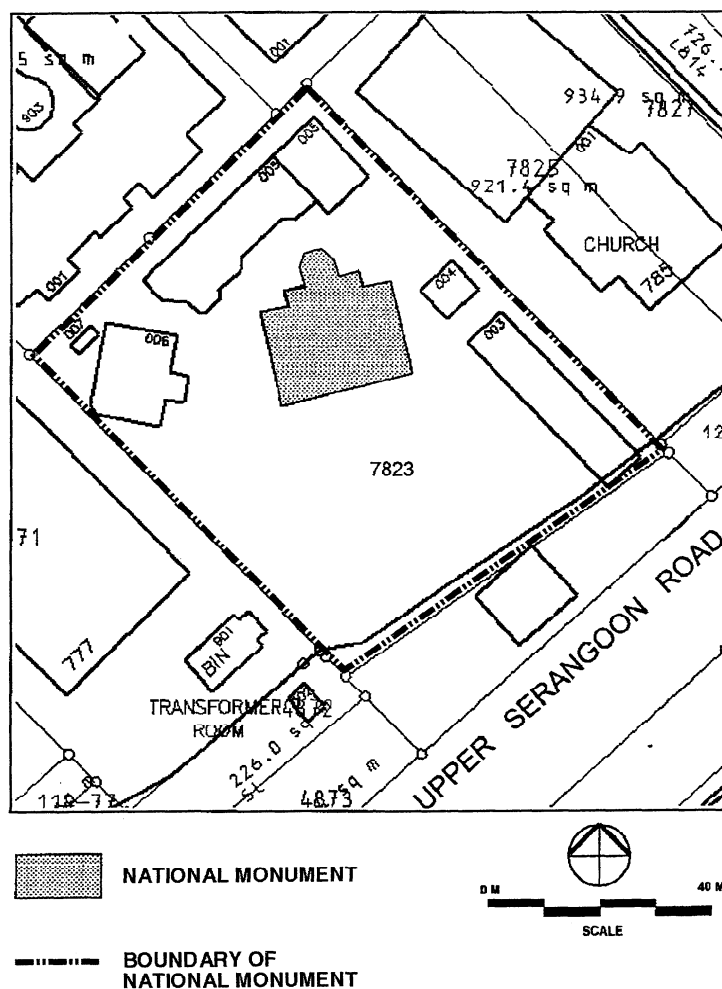

[S 33/2005 — 14.1.2005]

31.3.2005